

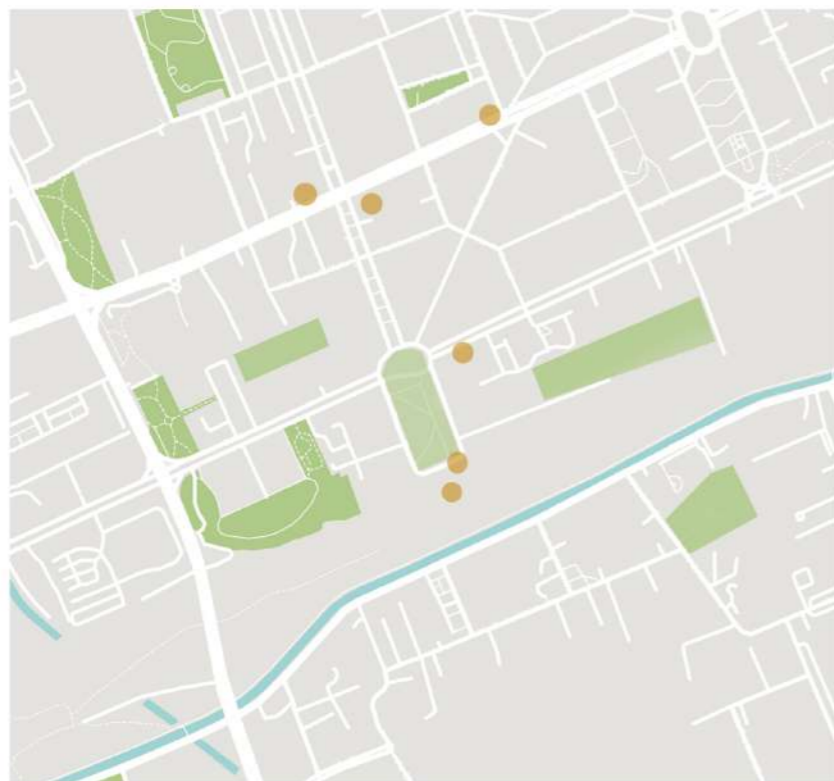

Group 7

Arta Aghaei
Raluca Chiriță
Marzena Cieniawska
Haruka Kajiura
Małgorzata Świeczka



Strengths:

1. Lots of green spaces.
2. Good and simple access to the public transport systems(Train, Metro, Bus, Tram).
3. Close proximity to sport complex, bike rental, play grounds and sport fields.
4. Good technical condition of buildings around.
5. surrounding historical buildings which Mostly have well preserved facades.
6. Numerous restaurants and service facilities in the area.

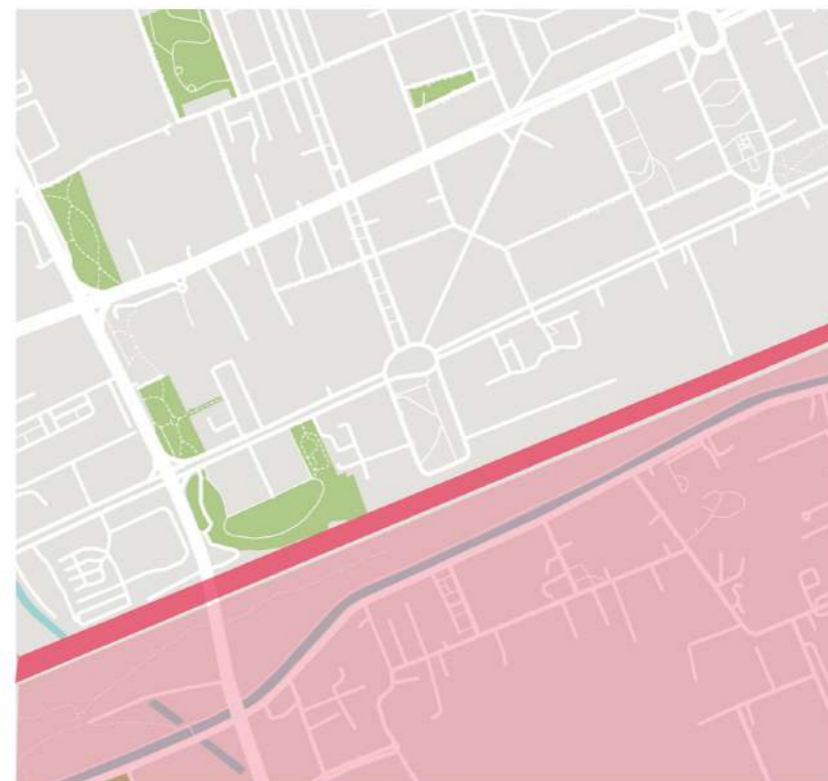

Weakness:

1. Not enough bike paths in the area.
2. No easy and safe crossing for rail roads.
3. Proximity to railway tracks leads to source of noise.
4. Not enough Praking lots.
5. Narrow streets which can not contain the traffic for the train station and other activities in the area.
6. No pedestrian crossing in front of the train station.



Opportunities

1. Seperated areas by railway can be connected by foot bridge/bicycle path.
2. The green spaces have potential to be design as attractive public spaces.
3. Flat terrain, allows easy terrarin contouring for the project.
4. The proximity of of the rail ways bus and tram lines and the planned metro station increases the traction of the designed space.
5. The possibility of creating a cultural center due to site history

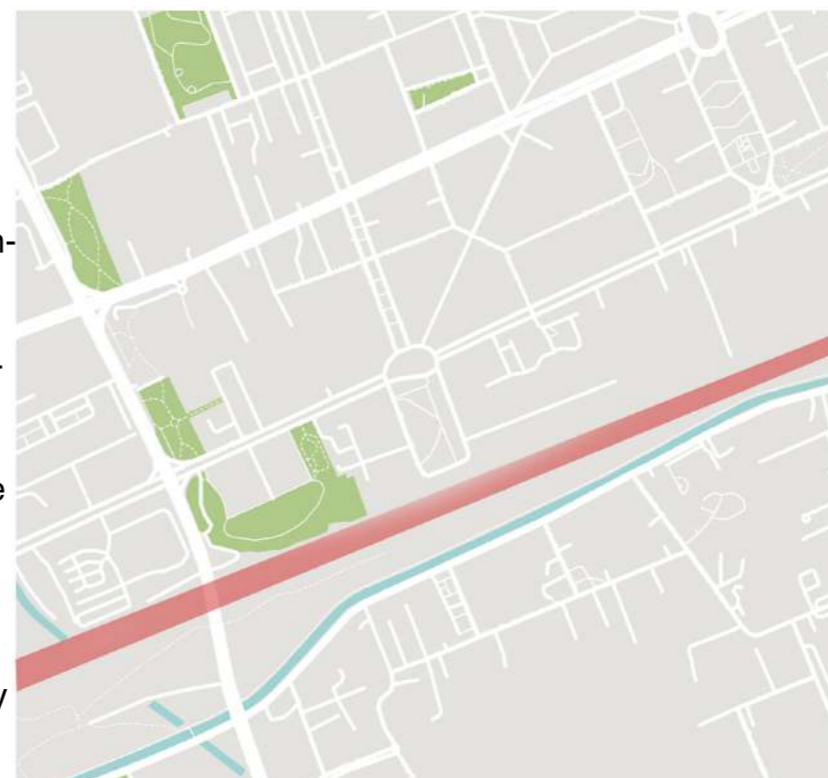

Threats:

1. Not enough Praking lots and narrow streets- it leads to traffic jams and parking cars on sidewalks
2. No easy and safe crossing for rail roads- This can result in illegal and dangerous crossing.
3. No pedestrian crossing in front of the train station- This can lead to accidents.
4. Proximity to railway tracks leads to source of noise- not comfortable and healthy to live near noise pollution.
5. Not enough bike paths in the area- leads riders to go on the street and cause traffic and accident.



Group 7

Arta Aghaei
Raluca Chiriță
Marzena Cieniawska
Haruka Kajiura
Małgorzata Świeczka

DIAGRAM ---Pathways---

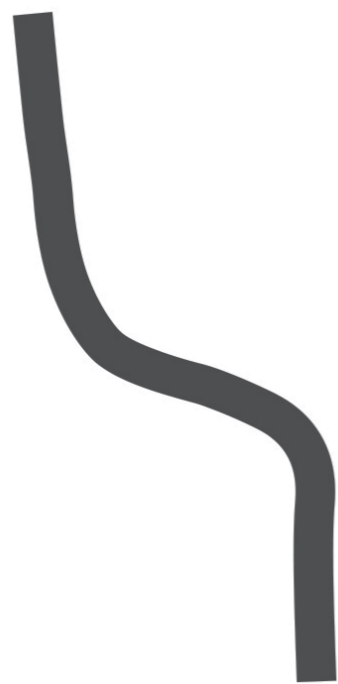



DIAGRAM ---Geometry---

Group 7

Arta Aghaei
Raluca Chiriță
Marzena Cieniawska
Haruka Kajiura
Małgorzata Świeczka



1. STRONG ELEMENT

This site has a bridge which is connected to the train station (Milano San Cristoforo). It is a strong element of this area and geometry as a design.

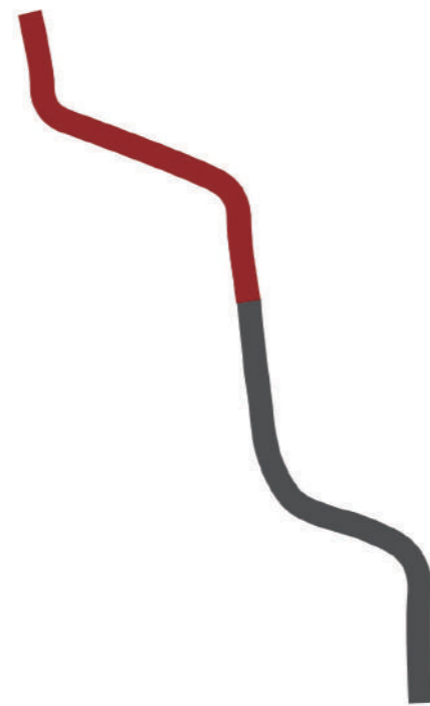

2. EXTEND THE LINE

The bridge line is extended to the top part of Piazza Tirana by following the same shape and pattern. We can go to the opposite side of site by this path.



3. ROTATE THE GEOMETRY

There is a main pathway that has been inspired by rotating the existing pattern which the intersection of these two pathways make spaces inside the area and have access to different activities.

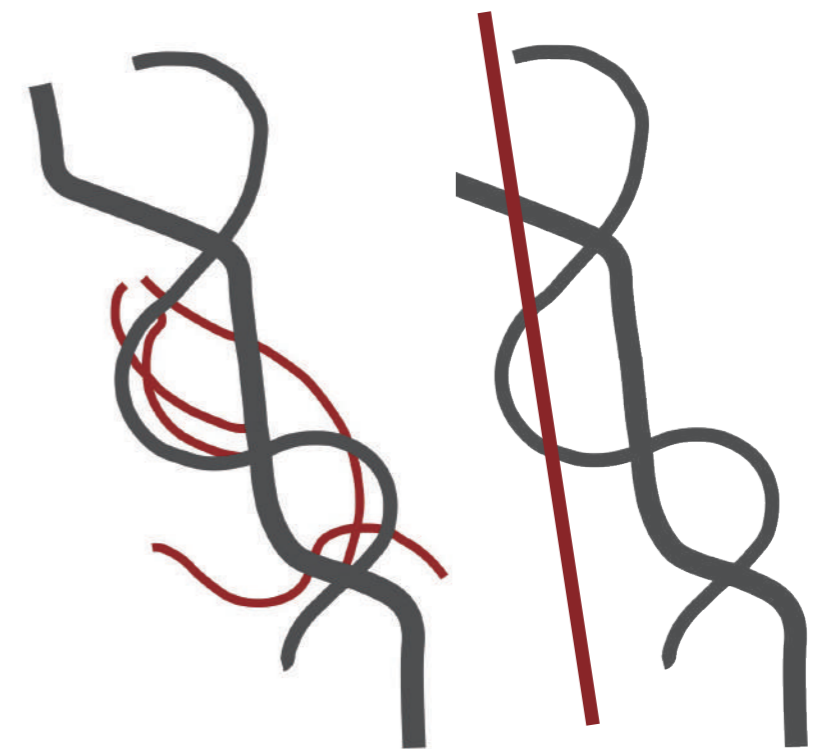

4. MAKE VARIOUS AREAS & PATHWAYS

There are also small pathways which they will provide secondary access between the spaces divided by two main roads and they will also make various of new small spaces in the area. And also the straight pathway allows us to go the opposite side of the site directly.



DIAGRAM --- Functions ---

Group 7

Arta Aghaei
Raluca Chiriță
Marzena Cieniawska
Haruka Kajiura
Małgorzata Świeczka

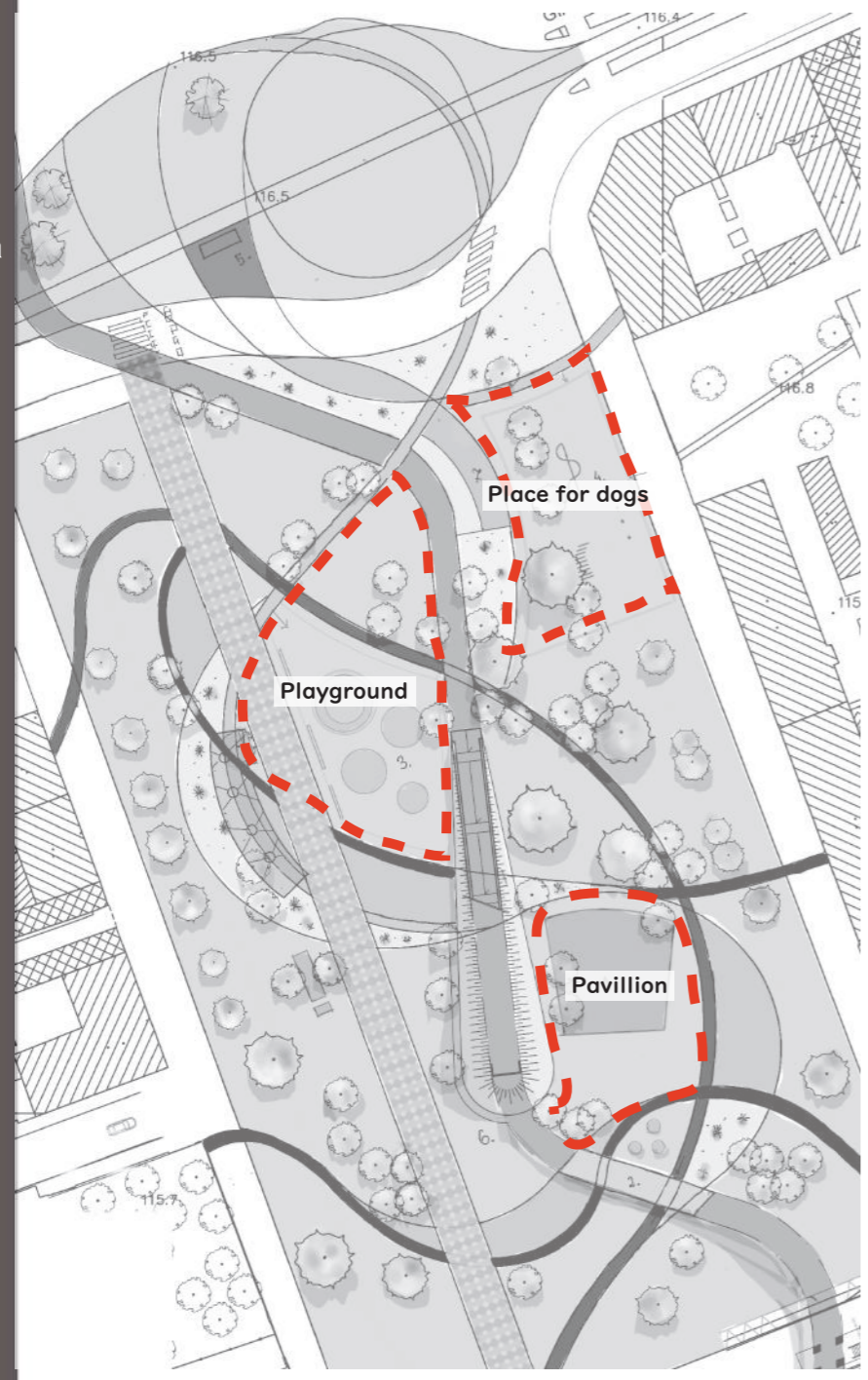

LIVELY FUNCTIONS

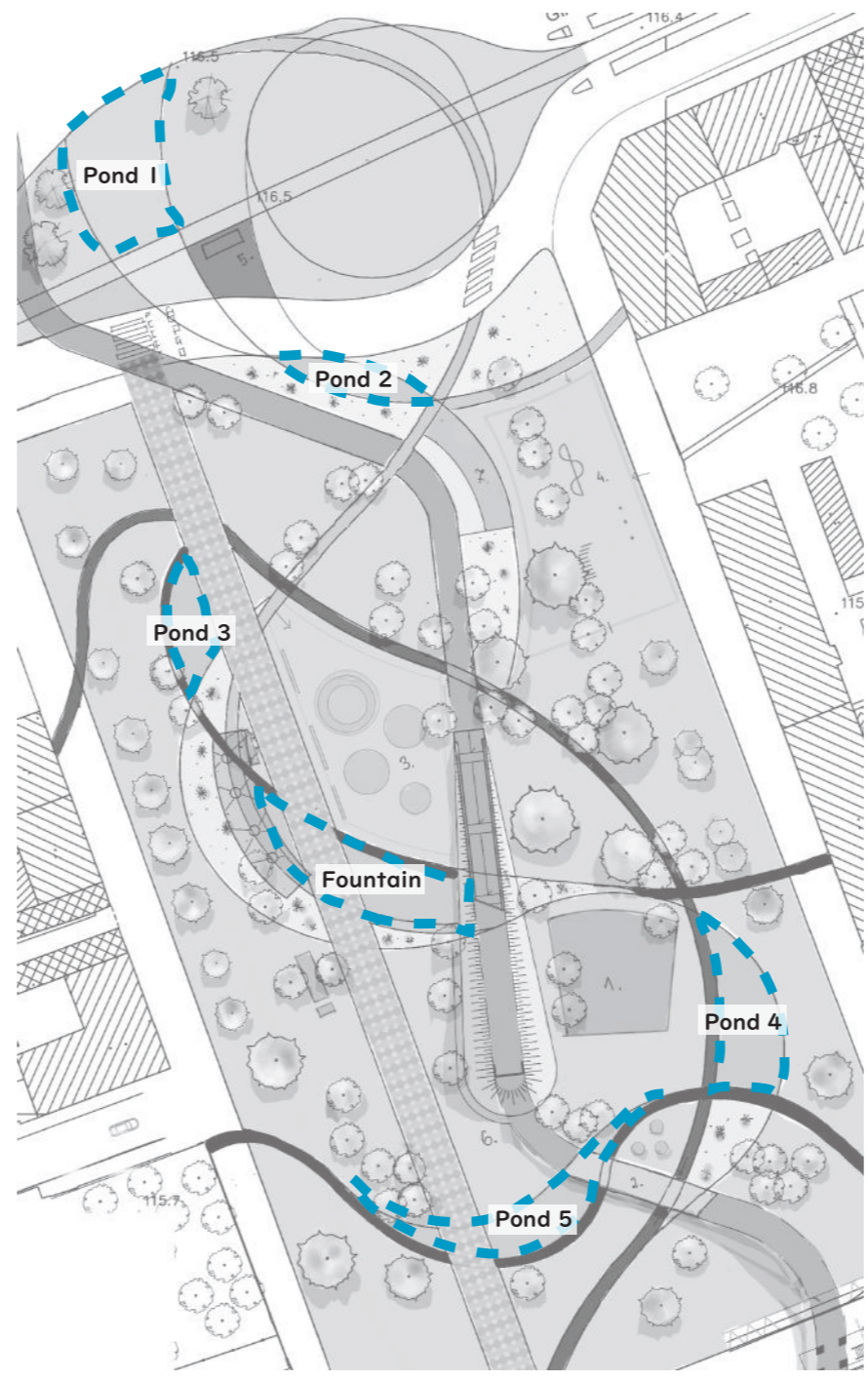

WATER FUNCTIONS

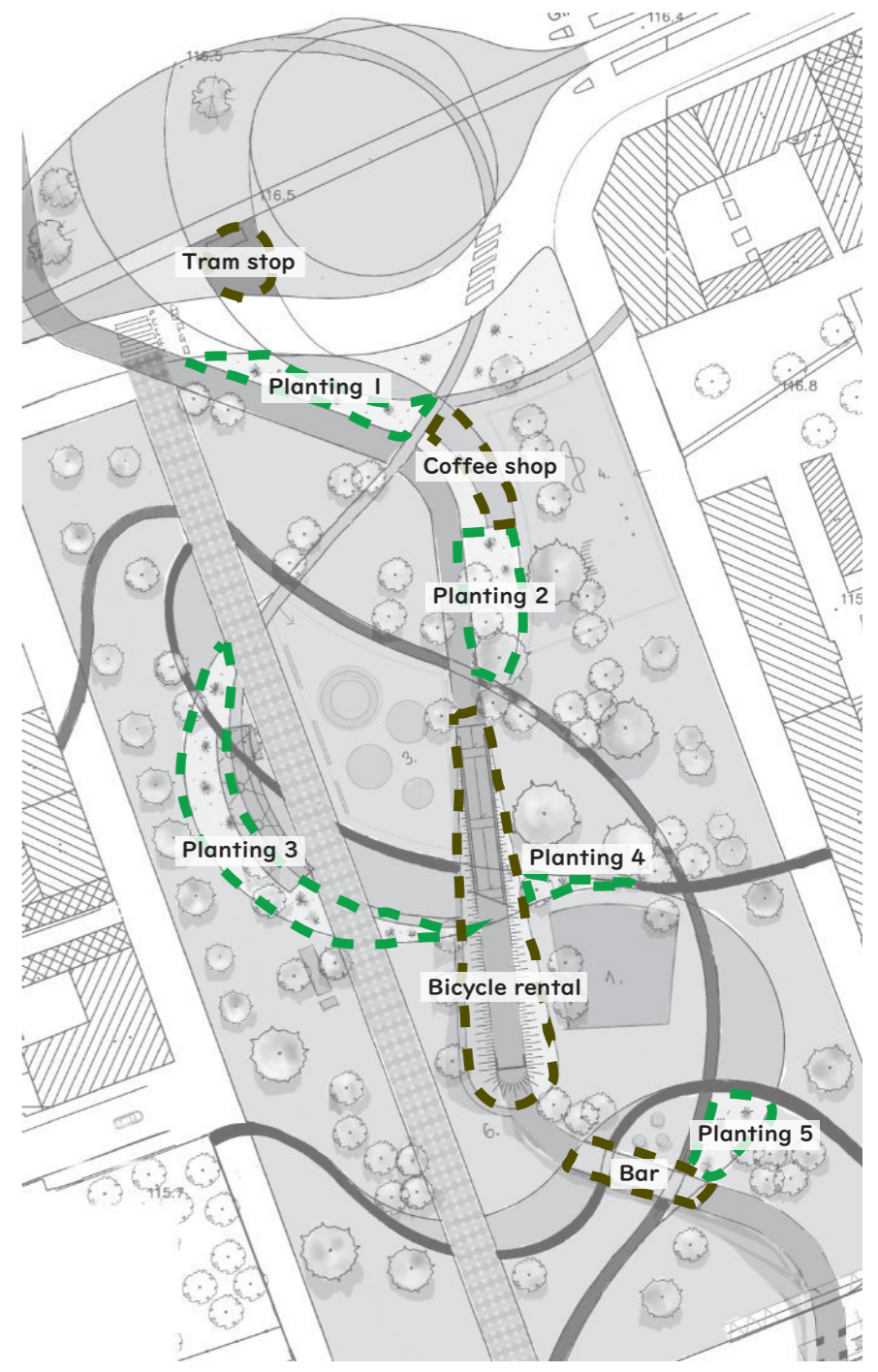

OTHER FUNCTIONS



Group 7

Arta Aghaei
Raluca Chiriță
Marzena Cieniawska
Haruka Kajiura
Małgorzata Świeczka

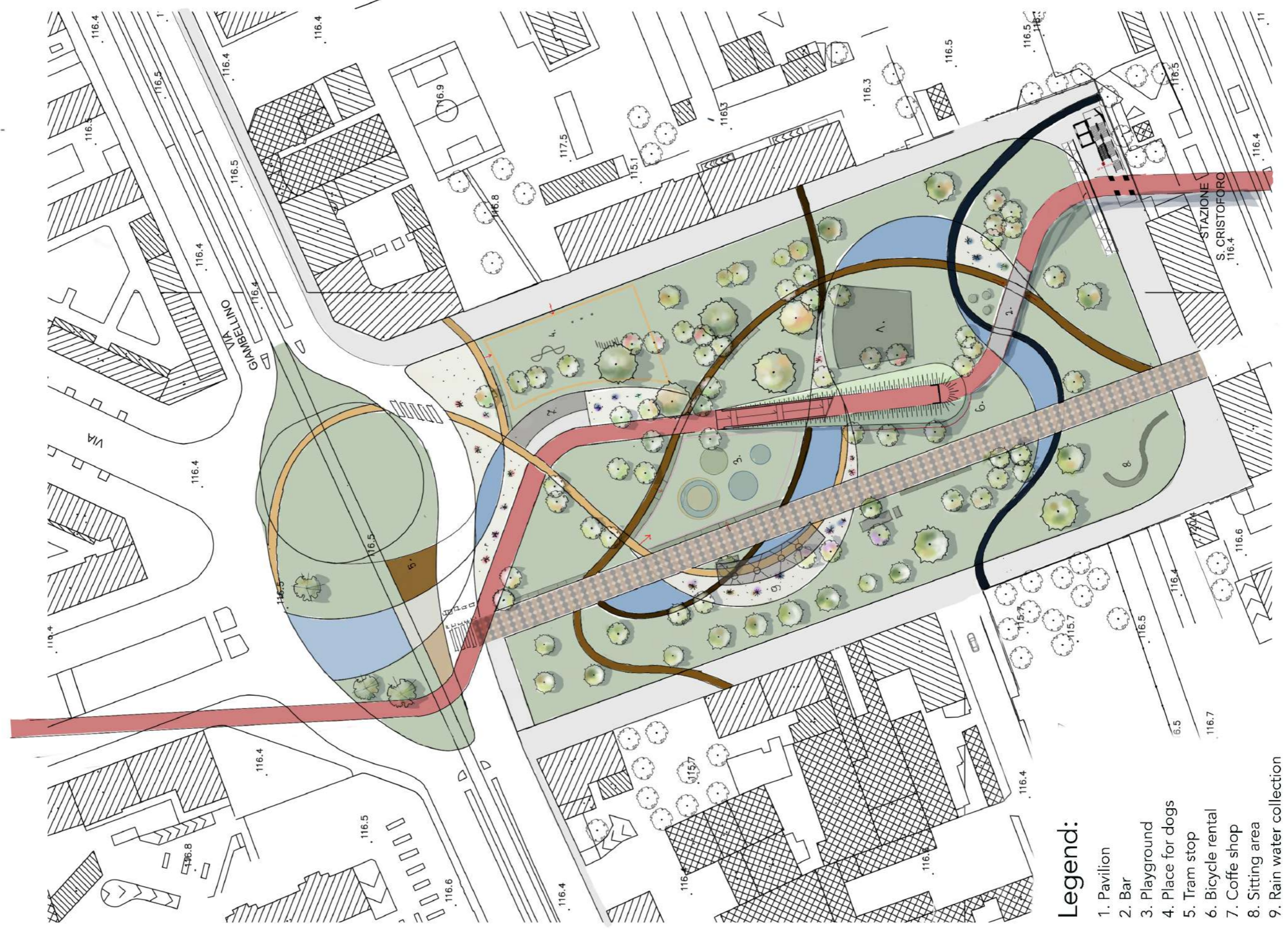

Legend:

- 1. Pavilion
- 2. Bar
- 3. Playground
- 4. Place for dogs
- 5. Tram stop
- 6. Bicycle rental
- 7. Coffe shop
- 8. Sitting area
- 9. Rain water collection



Group 7

Arta Aghaei
Raluca Chiriță
Marzena Cieniawska
Haruka Kajiura
Małgorzata Świeczka

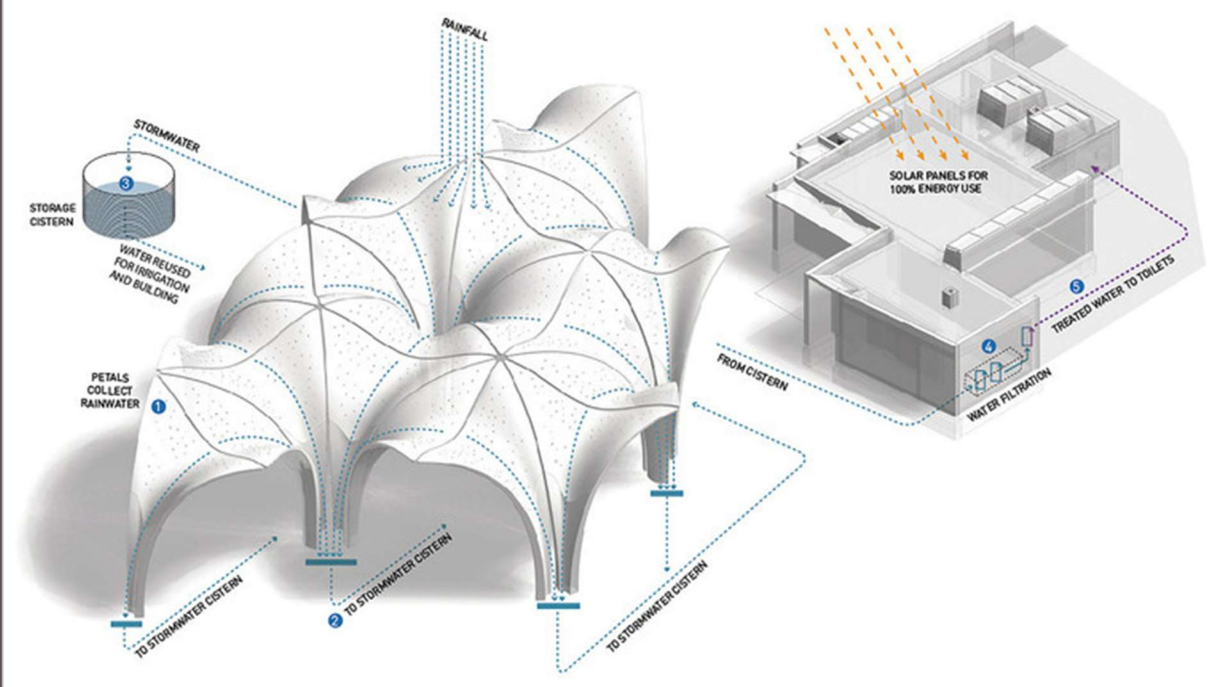

Solar powered pavilion by lake flato, matsys and rialto studio

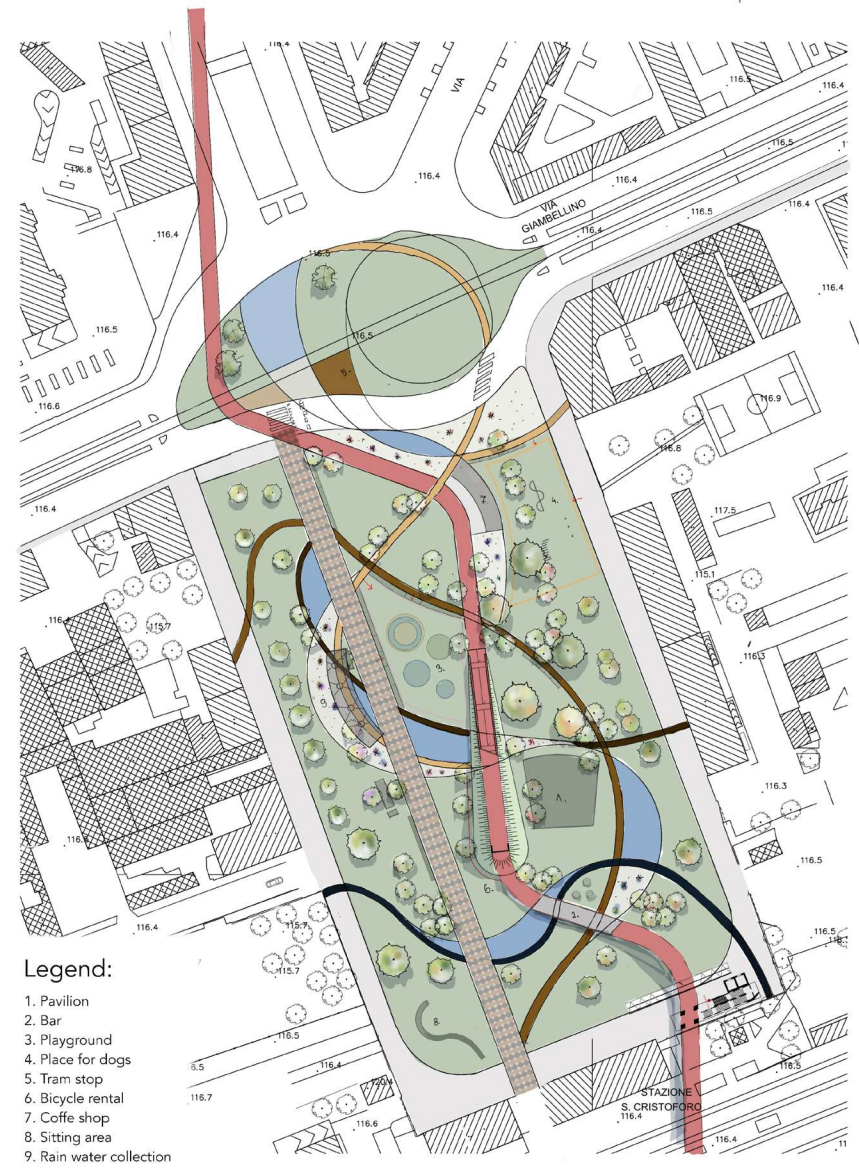
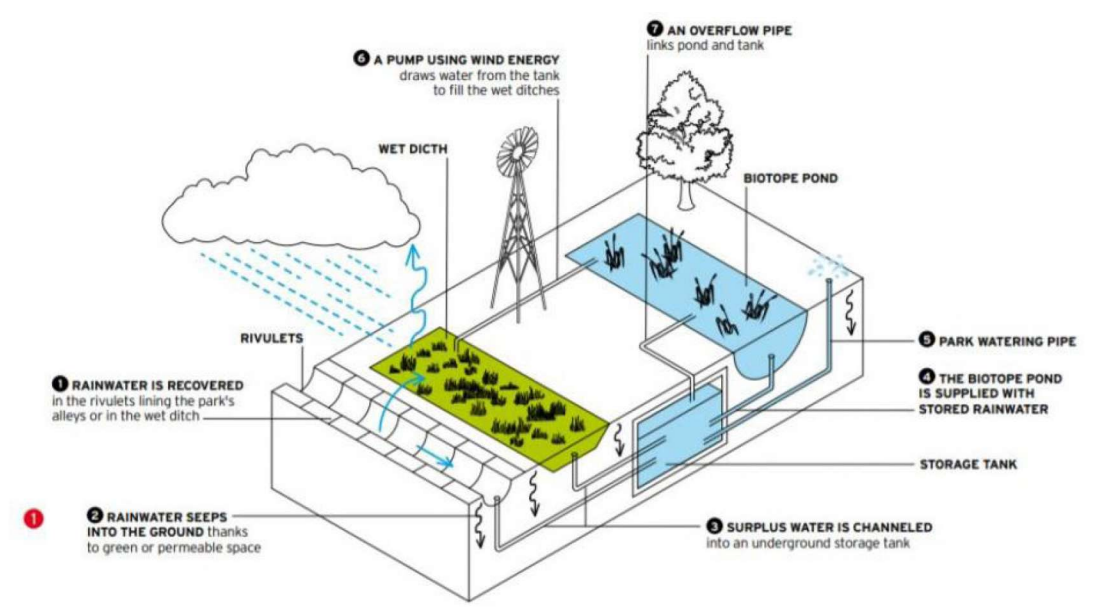

- Legend:
1. Pavilion
 2. Bar
 3. Playground
 4. Place for dogs
 5. Tram stop
 6. Bicycle rental
 7. Coffe shop
 8. Sitting area
 9. Rain water collection

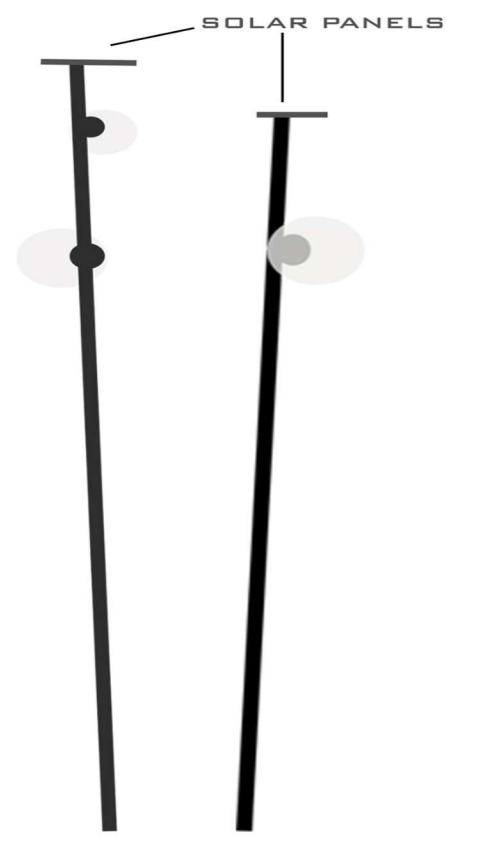

Sacred Allegory by Giovanni Bellini



Group 7

Arta Aghaei
Raluca Chiriță
Marzena Cieniawska
Haruka Kajiura
Małgorzata Świeczka





Group 7

Arta Aghaei
Raluca Chiriță
Marzena Cieniawska
Haruka Kajiura
Małgorzata Świeczka





Group 7

Arta Aghaei
Raluca Chiriță
Marzena Cieniawska
Haruka Kajiura
Małgorzata Świeczka

